

## Remote Alpha Loop Kit (BETA)

Instruction Guide, Version 1.6, November 5, 2019

### Description







The Remote Alpha Loop Kit enables Alpha Loop Antenna systems, which were purchased after January 1, 2017, to be retrofitted with a remote tuning option. Not for permanent outdoor use.

### Technical Overview

The Remote Alpha Loop Kit uses a custom Mount (F) to install the Motor (C) on an Alpha Loop. This Motor (C) is wired to a Controller (D), which enables remote tuning to occur. At the Mount (F), the Coupler (A) is used to connect the Nylon Shaft of the Variable Air Capacitor in the grey Alpha Match box to the Motor Shaft (C). Once installed, the Power Supply (B) is attached to the Controller (D). A Cable (E) is then used to connect the Motor (C) to the Controller (D). This remote kit is built for indoor use only and should not be installed outside.

### Parts List

Please ensure that you have received the following parts.

	A. Coupler		B. Power Supply
	C. Motor		D. Controller
	E. Cable		F.1.) Mount, F.2.) 1 nut

### Operations & Tuning

The Controller (D) has a potentiometer that can be turned on and increase/decreased to control Motor (C) speed. The switch in the Controller (D) can be toggled to move the Motor (D) left or right. The center position stops the Motor (C). There is a clutch assembly in the variable air capacitor that keeps the gears from being stripped. Initial tuning is best observed on your rigs S-Meter and then tweaked by transmitting while adjusting for lowest SWR on your rigs internal. For easier tuning use an external SWR Meter or Antenna Analyzer.

# $\alpha$ ALPHA ANTENNA®

## Installation

- 1) Make sure to turn the grey Alpha Match box over so that the nylon shaft is at the top.
- 2) Loosen the two (2) screws that hold the black knob already on the box, and slide it off the white nylon shaft.
- 3) Loosen the two (2) hex screws located on Coupler (A), which will face the grey Alpha Match box.
- 4a) While placing the Coupler (A) over the nylon (white) shaft of the capacitor, simultaneously place the notched Mount Hole (as depicted per 2b below) over the screw on the back of the grey Alpha Match box.
- 4b) Secure the Mount (F) to the screw on the back of the Alpha Match using the Nut (F.2.).
- 5) Then tighten all of the hex screws on Coupler (A).
- 6) Ensure the +/- wires from the Power Supply (B) are connected to the +/- terminals on the Controller (D).
- 7) Connect/secure the Cable (E) from the Motor (C) at the antenna to the Controller (D) +/- output terminals.

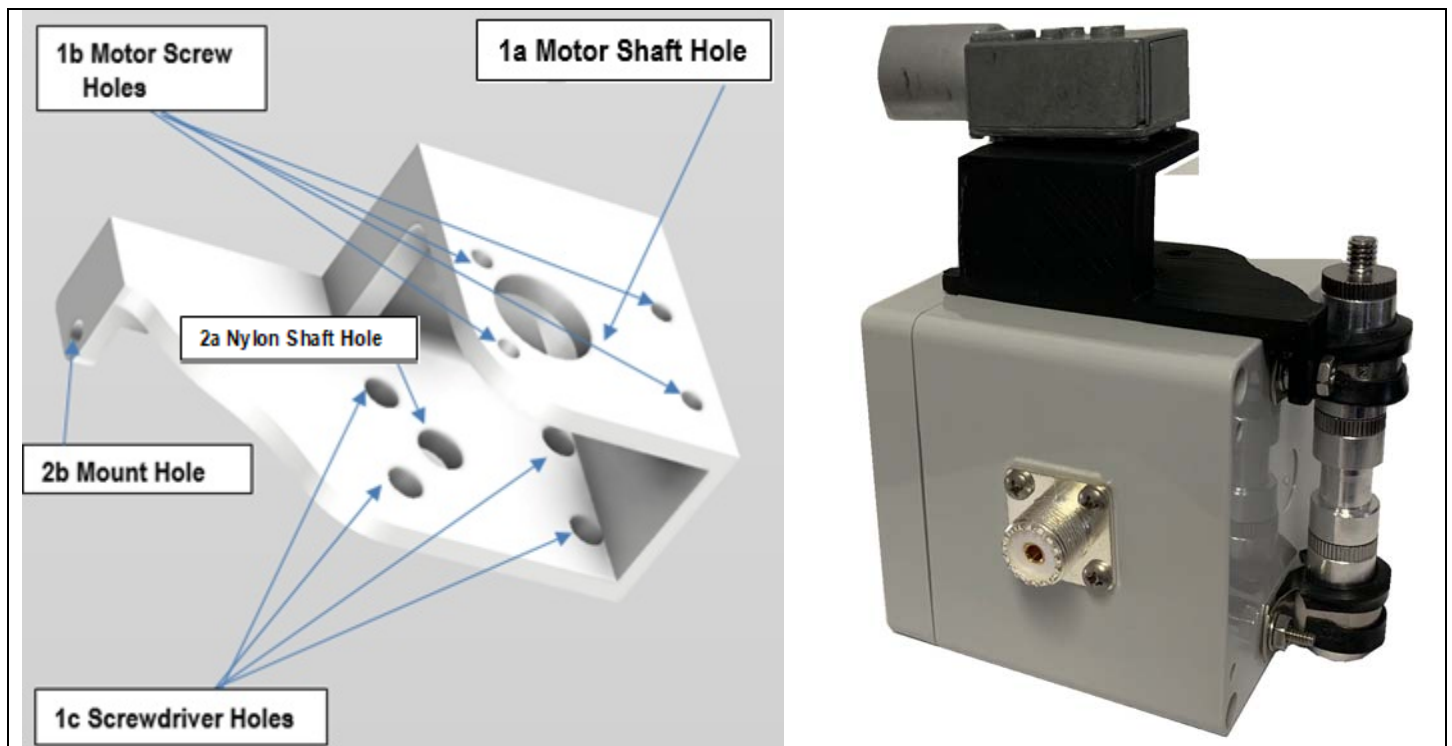

## Operation

- The knob on the Controller (D) controls turns the power on/off and also the speed of the Motor (C).
- The toggle switch on the Controller (D) can be flipped or down to tune the Alpha Loop.
- When the switch is on the Controller (D) in the center position the Motor (C) will stop.

## Support Contacts

If you have questions about your antenna, please feel free to contact us.

Email: [support@alphaantenna.com](mailto:support@alphaantenna.com) - Phone: 1-888-482-3249

WEB: [www.alphaantenna.com](http://www.alphaantenna.com)